

Polyurethane

HIGH RESISTANCE MAXIMUM ELASTICITY **MEGAFLEX®**

SEALINGS AND INSTALLATIONS REQUIRING HIGH RESISTANCE

Features

Megaflex Polyurethane is a waterproof sealant ideal for movement joints, which supports up to 25% permanent elasticity. Megaflex Polyurethane provides optimum resistance to weather and UV rays, without compromising mechanical resistance.

Megaflex Polyurethane is a flexible highly-adhesive caulk for sealing materials such as glass, metals, wood, concrete, masonry, or cement mortar.

Uses

Megaflex Polyurethane can be used to fill indoor or outdoor, vertical or horizontal, joints, in walls, floors, balconies, door and window frames, reservoirs, gutters, etc.

Carpentry, metalwork, doors, and windows.

Caulking.

Non-structural gluing of materials such as glass, wood or metal.

Advantages

Maximum elasticity and flexibility.

High mechanical resistance

Withstands work temperatures up to 130°C (266°F)

High performance and great adhesive power in different surfaces

Thoroughly waterproof, long-lasting joints.

Excellent resistance to aging and weather exposure.

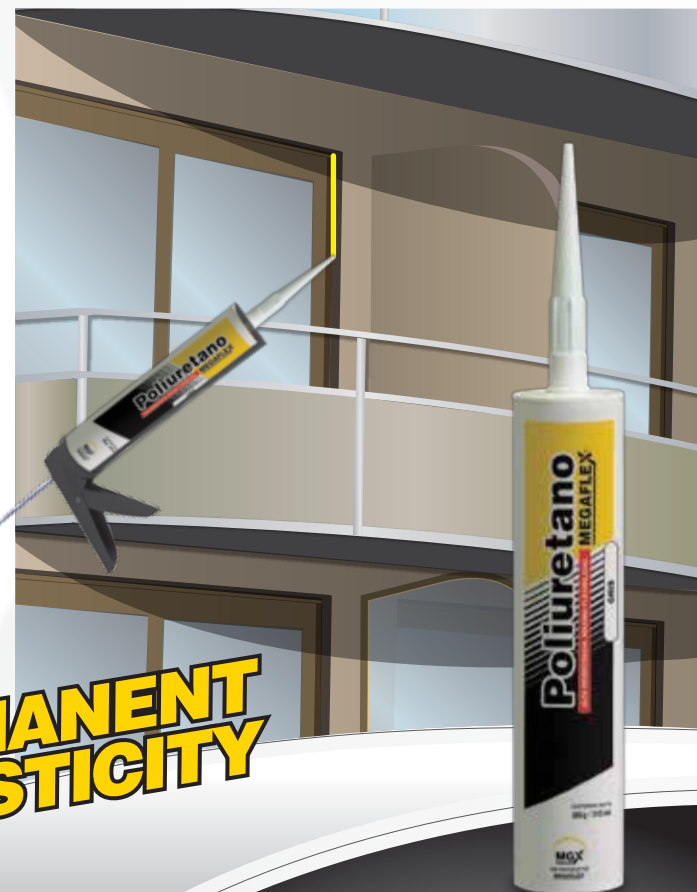

**PERMANENT
ELASTICITY**



B1852LGX, 1760 Luis M. Drago St., Burzaco, Almirante Brown Industrial District, Buenos Aires (Argentina) / Tel. / Fax: (54-11) 4002-5000 / E-mail: info@megaflex.com.ar / www.megaflex.com.ar / Technical Department: tecnico@megaflex.com.ar

Polyurethane

HIGH RESISTANCE MAXIMUM ELASTICITY **MEGAFLEX®**
SEALINGS AND INSTALLATIONS REQUIRING HIGH RESISTANCE

APPLICATION

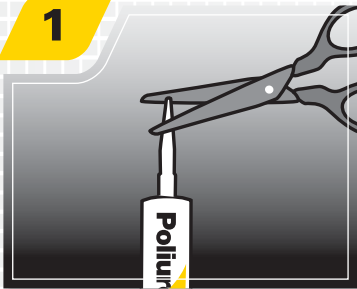
1

Before fitting the cartridge into the dispensing gun, cut the tip of the plastic nozzle at a 45° angle, as suitable. Cut the cartridge nozzle.

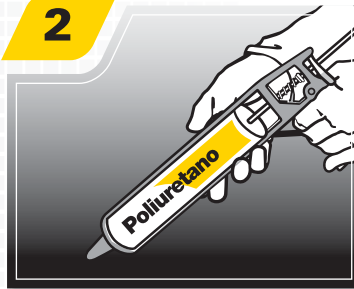
2

Fit into a suitable dispensing gun.

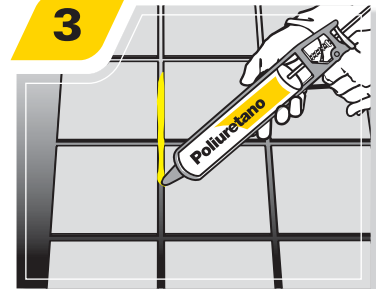
3

Apply Megaflex Polyurethane on the surface to be treated. Apply by pressing the nozzle onto the bottom of the joint, so as to prevent air bubbles from being formed.



Make sure the application surface is perfectly dry, clean, and free from dust or any other release agent.

Put the cap securely back in place after use to prevent the product from drying.

Recommendations

Use under good weather conditions.
 Surface curing is attained within 4 hs, whereas complete curing is attained in 7 days.
 Use elastic paints
 Use Megaflex Polyurethane preferably within 1 year of its manufacture date.

Yield

Joints 1 x 1 cm = 3 m/cartridge.

Storage

Store indoors, in a fresh, dry, and ventilated room, out of the reach of children and animals, and away from any source of heat.

Color

Grey

How Supplied

380-g / 310-ml cartridge with applicator
 12-units display pack boxes

Basic Composition

Polyurethane

First Aids

Skin contact: Remove the product using a clean cloth and vegetable oil. Wash with abundant water and soap. Apply moisturizing cream over the affected area.
 Contact with eyes: Wash with abundant water for at least 15 minutes. Contact a healthcare professional.
 Inhalation: Seek a fresh ventilated area.
 Intake: Do not induce vomit. Contact a healthcare professional.

Fact Sheets

Non-flammable product

Density: 1,20 g/cm³.
 Skin Formation Time: About 4 hours.
 Curing Speed: (3 mm every 24 hours).
 Application temperature: Less than 40°C (104°F).
 Working temperature: Up to 130°C (266°F); Constant: Less than 105°C (221°F).
 Minimum Temperature: -20°C (-4°F)
 Flow in Vertical Joints: -1 mm.
 Extrusion rate (2 kg pressure / 310 mL / 1-cm-diameter hole): less than a minute.
 Elongation at rupture (ASTM C 1135): 150, 60%.
 Tensile Strength at Break (ASTM C 1135): 0.67 Mpa.
 Hardness Shore A: 35-45.
 Resistance to UV Radiation (ASTM G 154): 500 h.
 Water Resistance: Resists.